

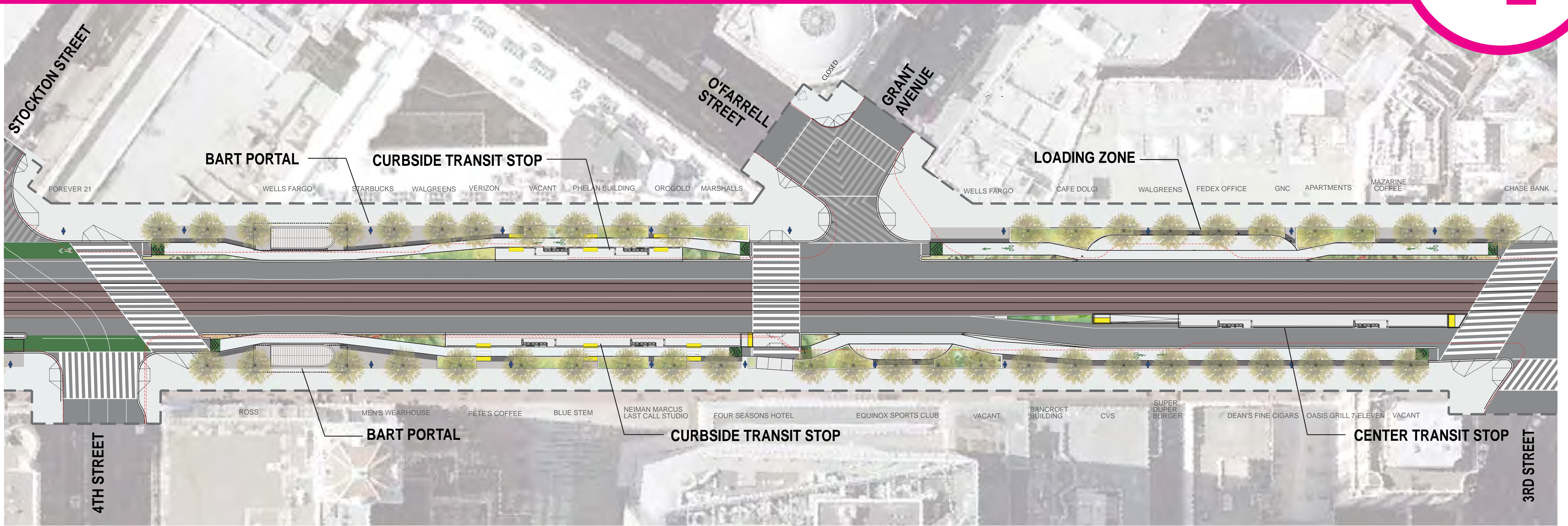

# TRANSIT STOPS



The project proposes to reconstruct all Market Street islands to be wide enough to provide full ADA accessibility, as well as more room for passengers to wait with better bus stop amenities, such as shelters with seating. In response to crowding, the proposed inbound stops would fit up to three 60' articulated buses simultaneously and outbound islands will be designed to accommodate up to two buses.

## CURBSIDE STOPS

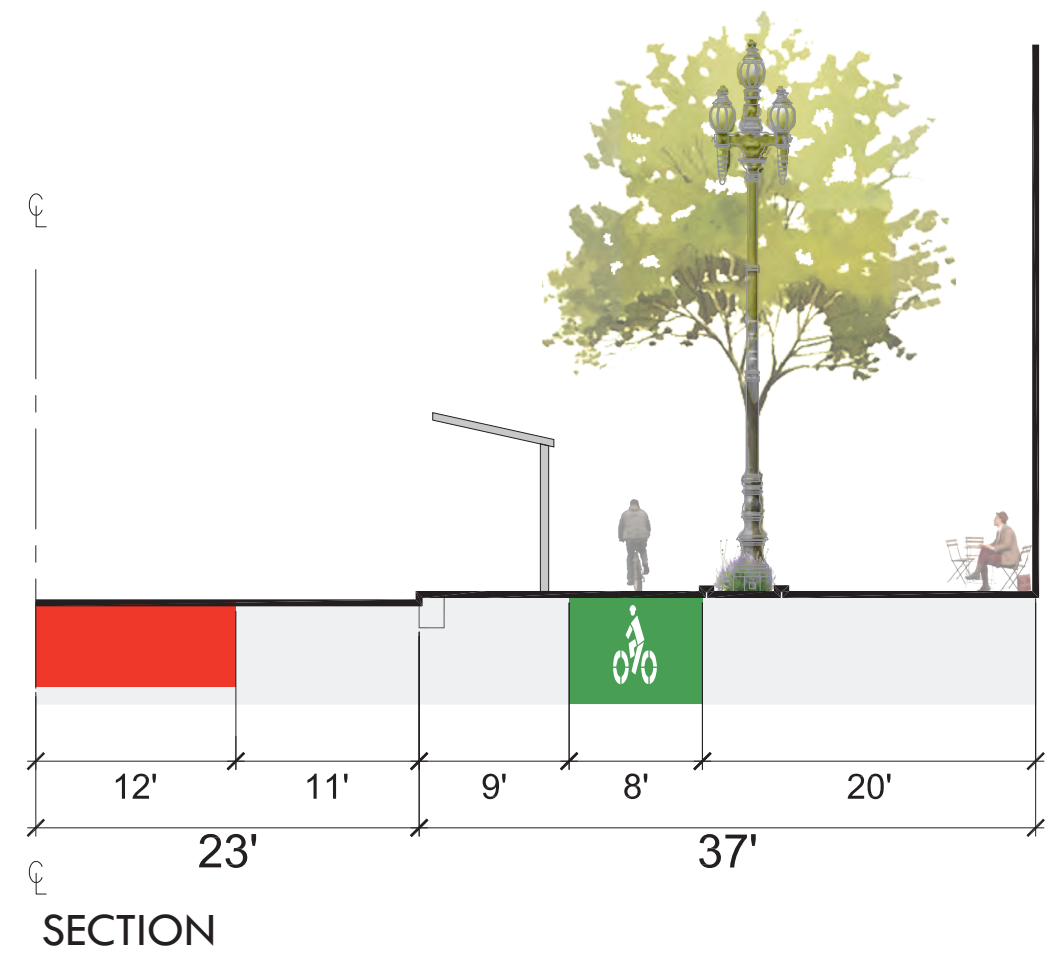

PLAN

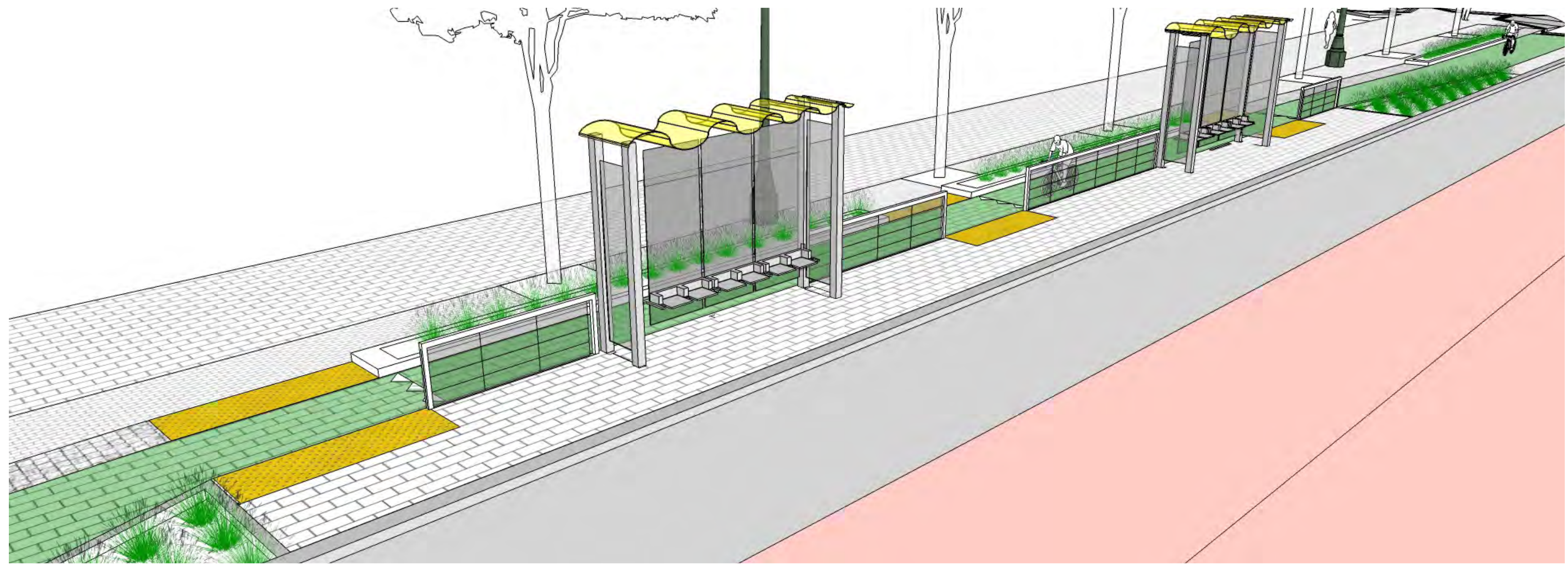

The new sidewalk-level bikeway would be placed between the curbside transit boarding island and the sidewalk. People accessing curbside transit would have designated places to cross the bikeway. Railings will help keep the number of locations where crossing the bikeway is encouraged to a minimum.

## CENTER STOPS

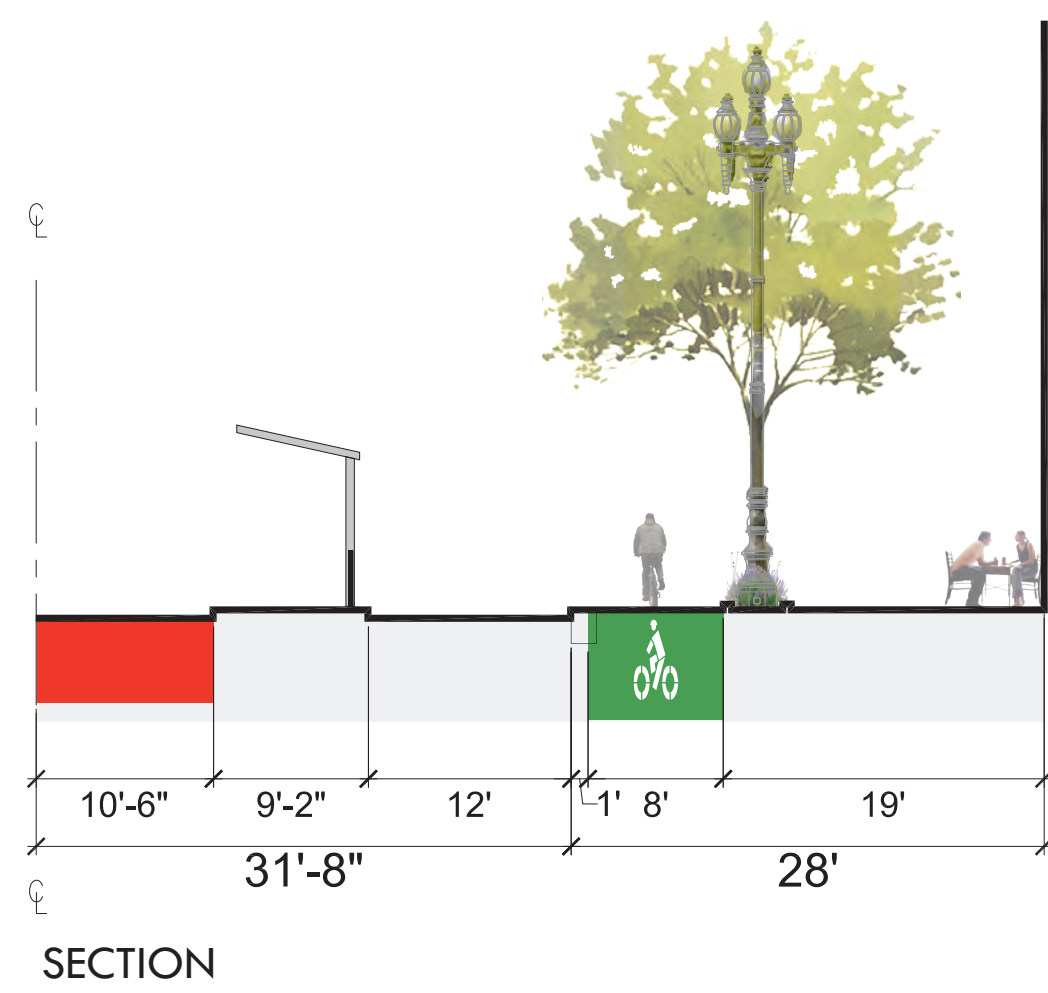

PLAN

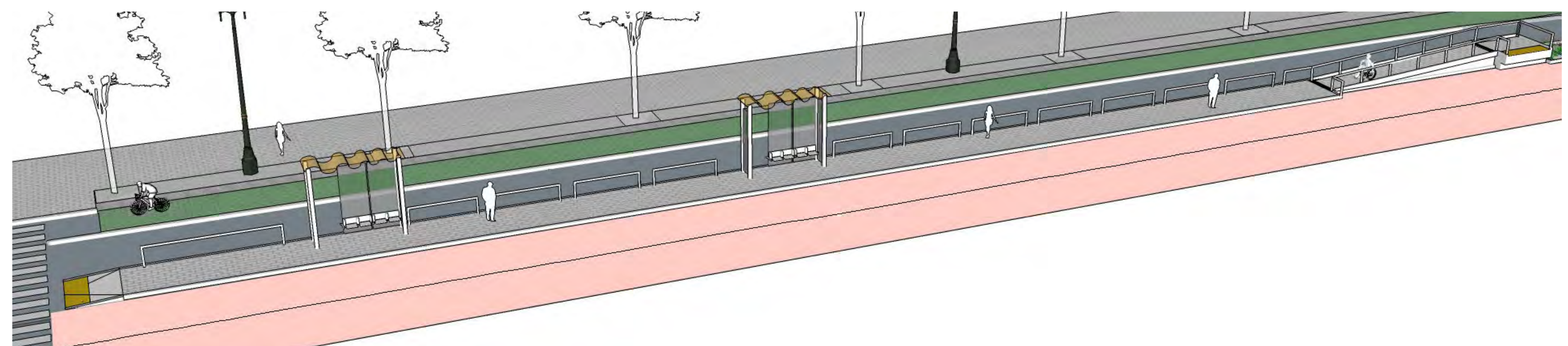

People accessing center transit boarding islands would cross to the center at designated locations with signalized crossings.

